



WK3
WORLD
KEYBOARD

New Operating System Release

English



Cod. 271137



.....
2 User Guide





• WK3 New Release

The latest release of the WK3 Operating System further enhances the instrument's automatic features and some of the RealTime specifications, adding five new functions to those already available. In addition, some of the general characteristics of the instrument have been optimized.

List of the optimized features

1. Disk Loading procedures.
2. The "Direct-from-Disk" procedure with MIDI Files containing Lyrics.
3. All types of MIDI Files.
4. Bass to lowest with first and second chord inversions.
5. Sound Banks.
6. Microphone sampling.
7. Effect editing.
8. Real Time Performances.
9. Song/Style recording.

The new functions are:

1. AUTO ARRANGE - an option which allows the Arrange On/Off button to be automatically activated by pressing the Start/Stop button when WK3 is set to operate in Style/RealTime mode. This method of enabling the Style accompaniment tracks ensures that the current Style is activated whenever you press Start/Stop. The option is disabled by default. You can enable Auto Arrange in the Arrange Mode/Split section. See "How to set the new functions" on page 4.

2. FINGERED 1 - an additional chord recognition function added to the existing three (the original "Fingered" option is renamed Fingered 2). When selected, Fingered 1 provides the full accompaniment pattern with a three note chord. With one or two notes, the chord is not recognised. Fingered 1 is accessed on page 2/3 of the Arrange Mode/Split section. See "How to set the new functions" on page 5.

3. AUTO NAME - if you save a single file to disk (Song, Style, MIDIFile), the original name of the file is copied to RAM and then to floppy disk. This provides you with two possibilities: a) you can save the file to disk with its original name (avoiding the additional step of writing a name for the file) or, b) save the file with a different name.

Refer to the example on page 7 for details of how save a file using the Auto name function.

4. PRESELECT SONG OR STYLE MODE DURING PLAY - While WK3 is in Style or Song playback mode, it is possible to preselect a different playing mode. This allows automatic entry into the preselected mode the instant you press Stop, without having to carry out additional selections of the required Song or Style.

5. OPTIMIZATION OF THE WS COMPATIBILITY - The recognition of Disk-based WS Songs and Styles has been optimized further, both in Play mode as well as in Loading situations, permitting a wider listening possibility of all WS backing files. In addition, a conversion programme has been implemented, compatible with the Atari, which permits the reading of WS files created using the "Chain compose" feature. For further information, contact your nearest Generalmusic dealer.



How to set the new functions

AUTO ARRANGE

WK3 is factory-programmed to power up with the AUTO ARRANGE function disabled. When you press START/STOP, the Arrange On/Off button remains off and only the Drum track of the Style starts to play, allowing you to play the keyboard sounds with drums only.

You can enable auto Arrange so that pressing Start/Stop automatically activates the ARRANGE ON/OFF button (LED on). Whenever you press Start/Stop, you will be able to play with the Style auto accompaniments by playing a note or chord on the lower part of the keyboard (below the split point).

How to change the status of the Auto Arrange function.

1. Press the ARRANGE MODE/SPLIT button to open the first page.
2. Press PAGE+ twice to open page 3.
The display shows two options to choose from.
3. Select the AUTO ARRANGE function.
Use function buttons F4 or F5.
4. Set the function accordingly (On or Off).
Press the same function button repeatedly to toggle between the ON and OFF status.
5. Press ESCAPE to close the display.

► Note: the Auto Arrange function is valid for Style/RealTime mode only.

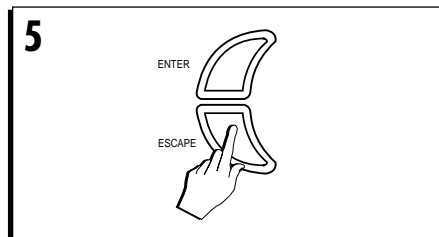
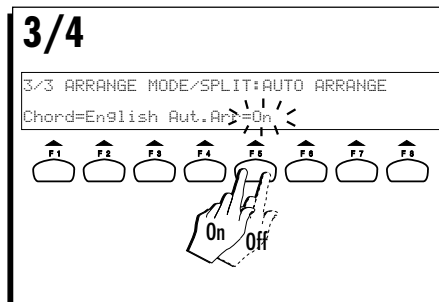
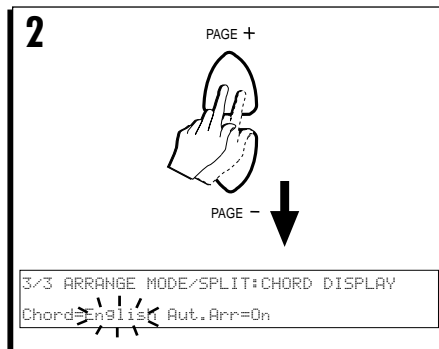
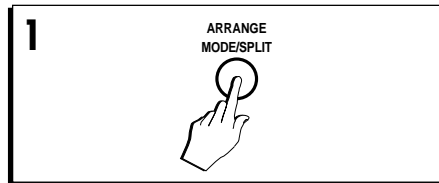



FINGERED 1

The Chord recognition options offered with the new release are now 4: One Finger, Fingered 1, Fingered 2 and FreeStyle.

[See page 5.11 of the Style Chapter in the User Guide of the WK3 Owner's manual for information regarding the chord recognition modes).

► **Note:** In order for the chords to be recognized (and the relative symbol to be displayed), ARRANGE ON/OFF must be on.

The new Fingered options

Fingered 1 - needs at least three notes for the chord to be recognized. If less than three notes are played, the chord is not recognized and the notes played in the left hand are considered 'stray' notes.

Fingered 2 - [originally "Fingered"] at least three notes must be played to obtain the full programmed pattern of the Style. If less than three notes are played, the arranger recognizes the chord but only triggers a light accompaniment. Two fingers provides a slightly richer accompaniment than one finger.

How to set the new Fingered 1 option

1. Press the ARRANGE MODE/SPLIT button to open the first page.
2. Press PAGE + once to open page 2.

The display shows four options to choose from. The one currently selected is shown flashing.

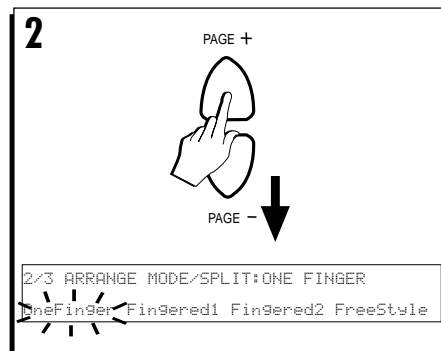
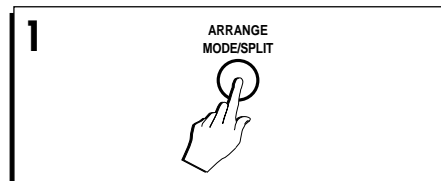



Fingered 1

3. Select the FINGERED 1 function.

Use function buttons F3 or F4. The selected function starts to flash.

4. Press ESCAPE to close the display.

The setting is a Performance parameter which can be stored to the current Performance by pressing STORE PERF then ENTER.

If you fail or forget to save the setting, it will remain selected until you modify the setting again or until you select a different operating mode (i.e. Song mode). In such cases, the original chord recognition setting will be restored.

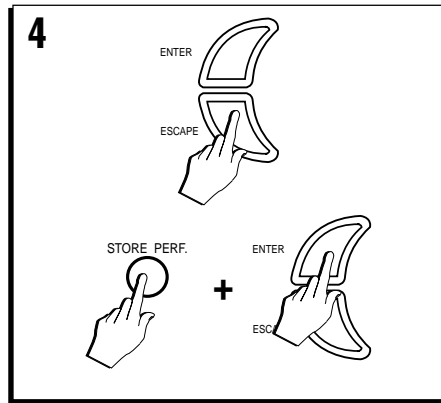
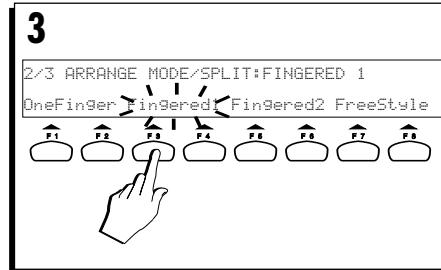

6 User Guide





AUTO NAME

When you are working with Disks and, in particular, saving single files, WK3 now offers the choice of saving with the original file name. With the previous release, all save operations for single files required that you write the name of the file before confirming the save operation. With the new release, you can skip the name writing step and save the file with its original name. The names of the Song files appear in the file directory.

Example: Save a single Song

The following example explains how to Save a single Song file with the original name. Use the same procedure for a single Style or MIDIFile.

1. Have a new or used WK3 disk ready and insert it into the drive.

You can prepare a new WK3 disk with the "Format 1,44 MB" or "Format 720 Kb" operations in the "Utility" Disk page.

If the disk is write protected, remove the protection.

2. Press DISK.
3. Press PAGE+ twice to pass to the "Save" page.

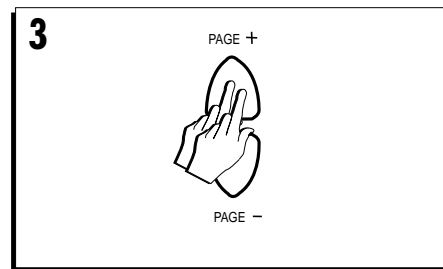
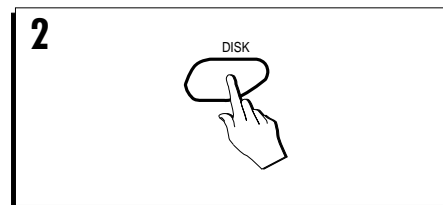
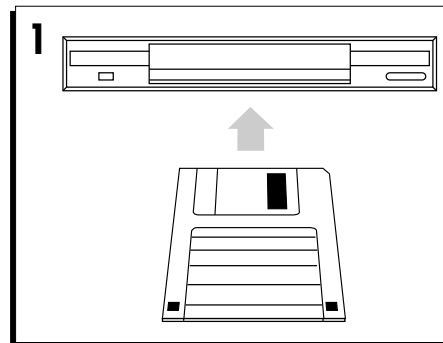



4. Select the Song option.

Use function button F2 to save a Song.

The Song directory is displayed showing one or more Song names to choose from.

5. Select the Song that you wish to save to disk.

6. Press ENTER.

You are prompted with a request to save the Song with its original name, or to write a new name for the file.

7. Press ENTER twice to save the Song with its original name.

Pressing ENTER the first time displays a request to reconfirm the operation (Are you sure?). Pressing ENTER a second time starts the save procedure. To cancel the operation, press ESCAPE.

With ENTER, the drive starts running and the display flashes the phrase "Saving" during the save procedure.

When the message ceases to appear, the Song is saved to disk.

► **Remember:** If you save a Song whose name already exists on disk, the disk-based file with the same name will be cancelled.

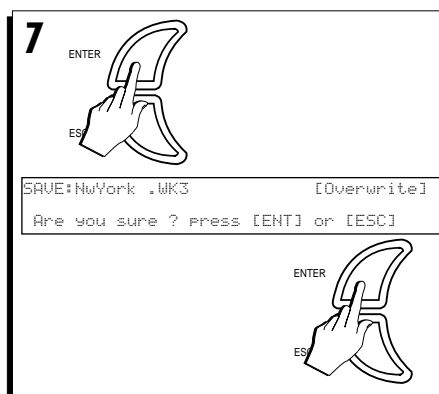
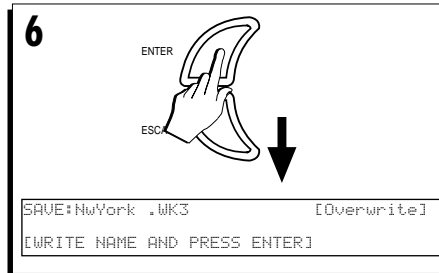
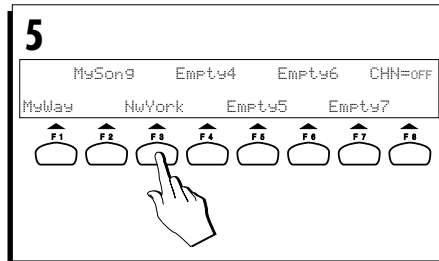
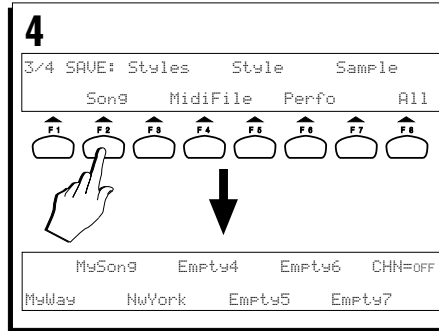

8 User Guide

